

ALLDAY  
& MILLER



Maylands Drive, Uxbridge, UB8 1BH  
£675,000

 3  1  2  C



Maylands Drive, Uxbridge, UB8 1BH

**£675,000**

- Three Bedroom
- Planning Permission Granted For Extensions
- North Uxbridge Cul De sAC
- Outstanding School Catchments
- Semi Detached
- Garage Via Own Driveway
- Large Rear Garden
- Close To Uxbridge Station

## Description

The living accommodation currently comprises of entrance hallway, ground floor w.c., two inter connecting reception rooms that could be a through lounge or separate, the dining area opens up onto the garden, the kitchen and utility room complete the ground floor. The first floor has three double bedrooms and a family bathroom, the loft is a great space with huge potential.

Please see the attached planning permission documents for the future extensions to the side and rear

The front provides parking and driveway to the garage. The rear garden is a peaceful space with an attractive lawn and garage. measuring approx. 80ft

## Situation

Maylands Drive is situated on the North side of Uxbridge, a short walk to the High Street that offers two shopping mall's, numerous restaurants, cocktail bar's and for the commuter, Uxbridge Tube Station offers Metropolitan and Piccadilly line services into Central London. Other amenities close by include Brunel University, Hillingdon Hospital and Stockley Business Park. The area is also served by a selection of well-regarded infant, primary and secondary schools.



## Floor Plans

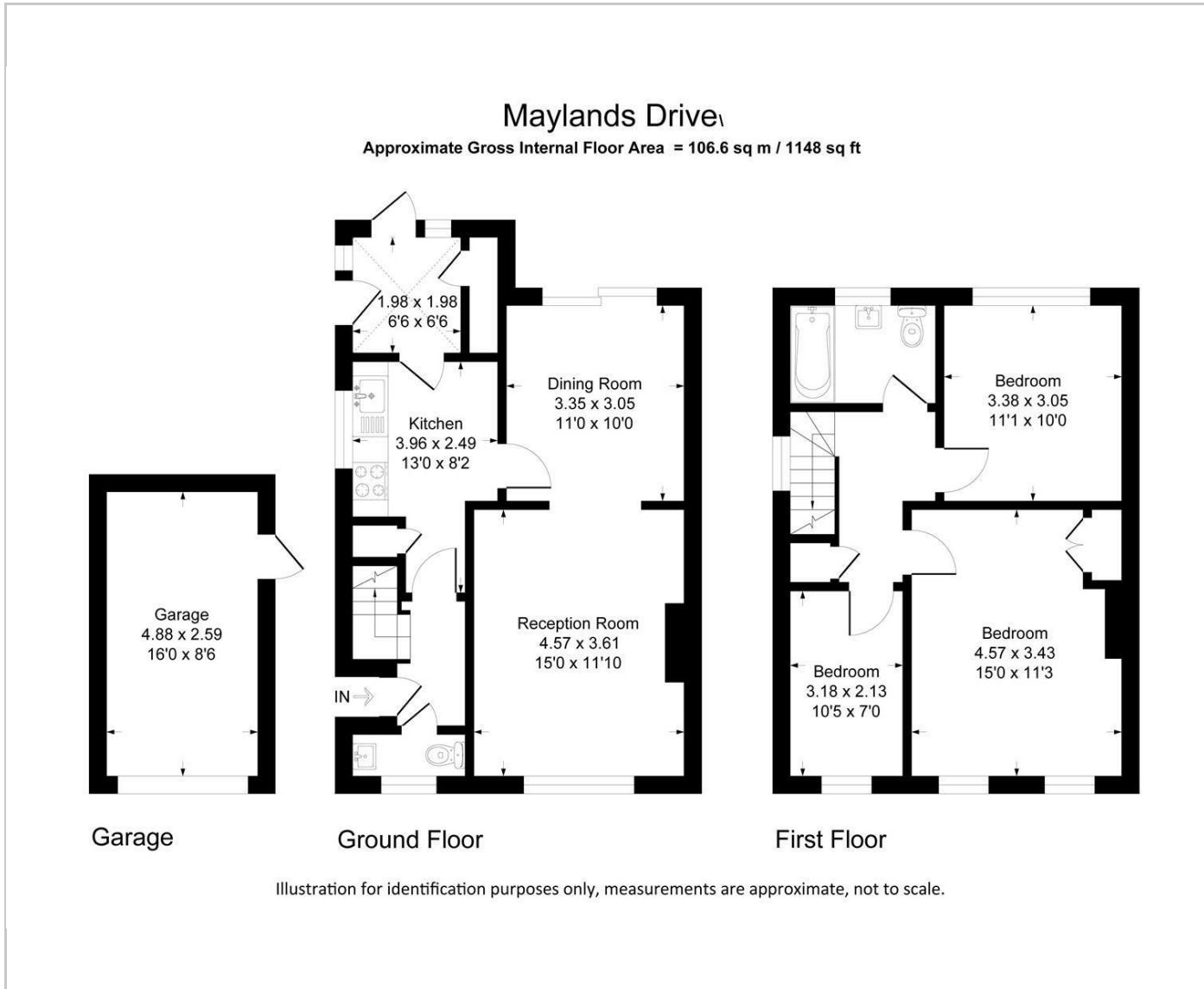

## Area Map

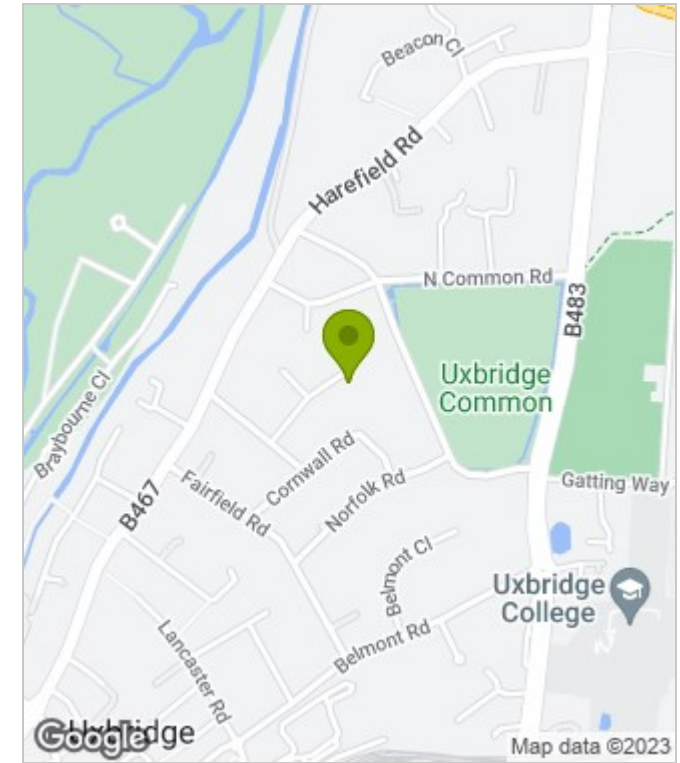

## Energy Performance Graph

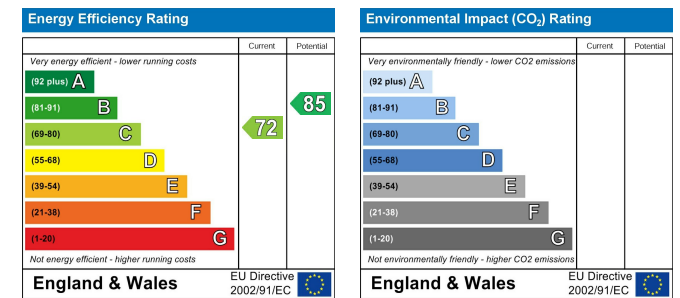

These particulars, whilst believed to be accurate are set out as a general outline only for guidance and do not constitute any part of an offer or contract. Intending purchasers should not rely on them as statements of representation of fact, but must satisfy themselves by inspection or otherwise as to their accuracy. No person in this firm's employment has the authority to make or give any representation or warranty in respect of the property.